

# STAGE N1

## Key Plan

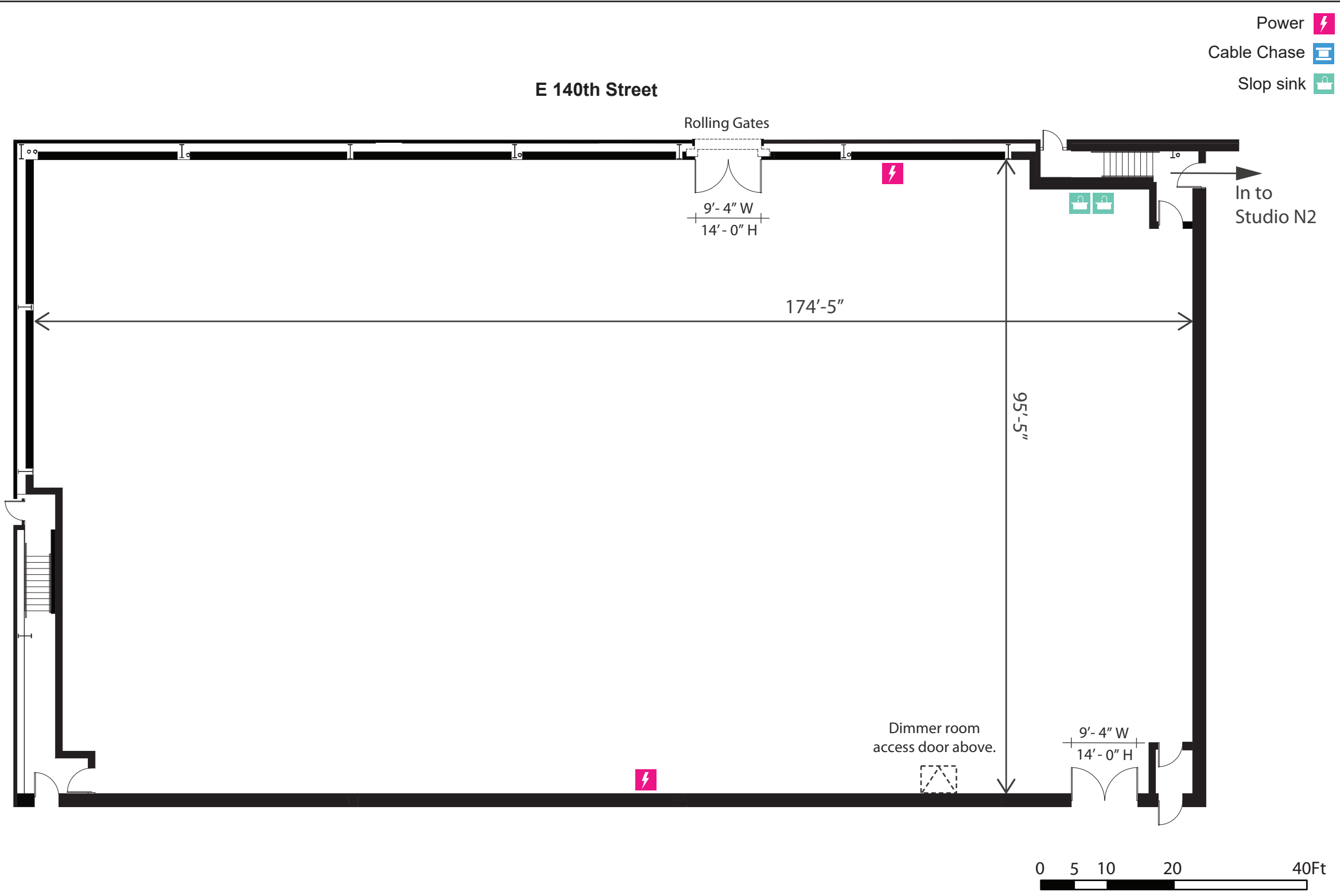
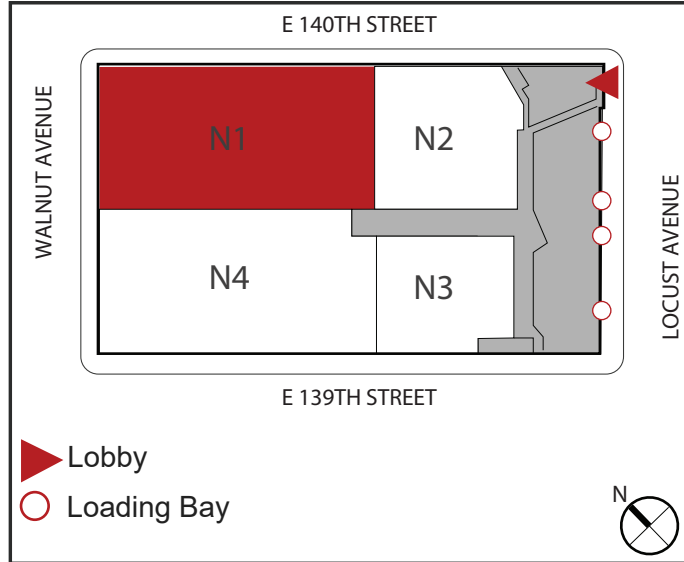

2 Power Panels each 1200Amps located in the Dimmer Rm.- To be pulled from access door.  
Additional shared 4800Amps in the hallway.

SILVERCUP STUDIOS	Length	Width	Ht to Grid	Ht to Truss	Approx Area	Power	AC	Floor type	Cyc
	174'- 5"	95'-5"	50'- 0"	49'-0"	16,220 sqft	4800 Amps	100 Tons	Finished Concrete	None

# STAGE N2

## Key Plan

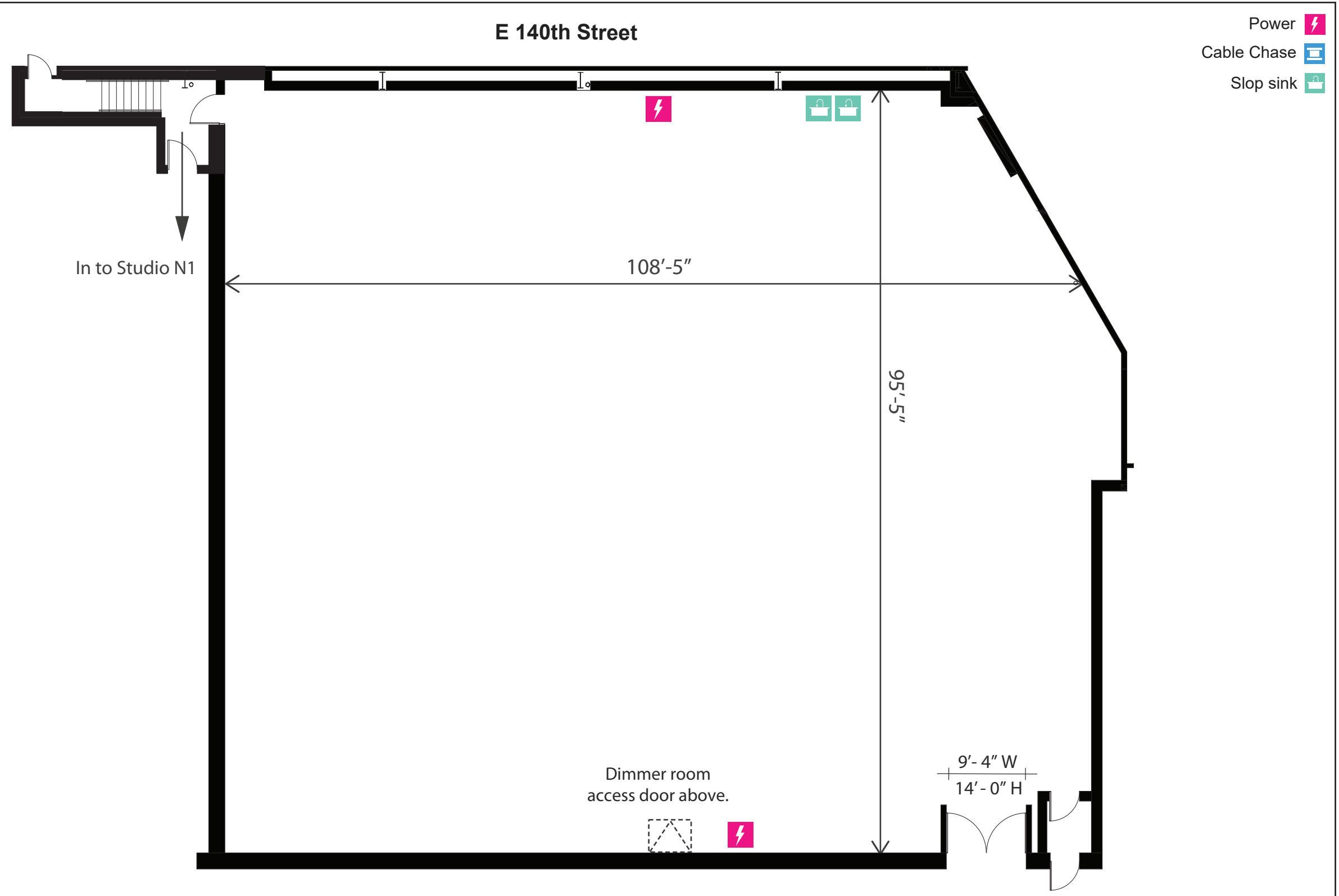
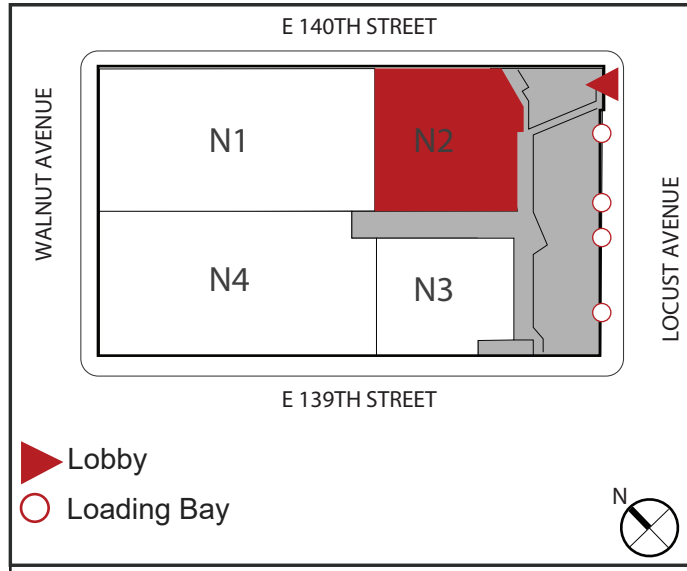

- Power
- Cable Chase
- Slop sink

2 Power Panels each 1200Amps located in the Dimmer Rm.- To be pulled from access door.  
Additional shared 4800Amps in the hallway.

SILVERCUP STUDIOS	Length	Width	Ht to Grid	Ht to Truss	Approx Area	Power	AC	Floor type	Cyc
	108'- 5"	95'-5"	50'- 0"	49'-0"	10,171 sqft	4800 Amps	75 Tons	Finished Concrete	None

# STAGE N3

## Key Plan

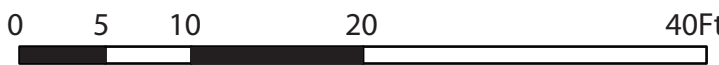
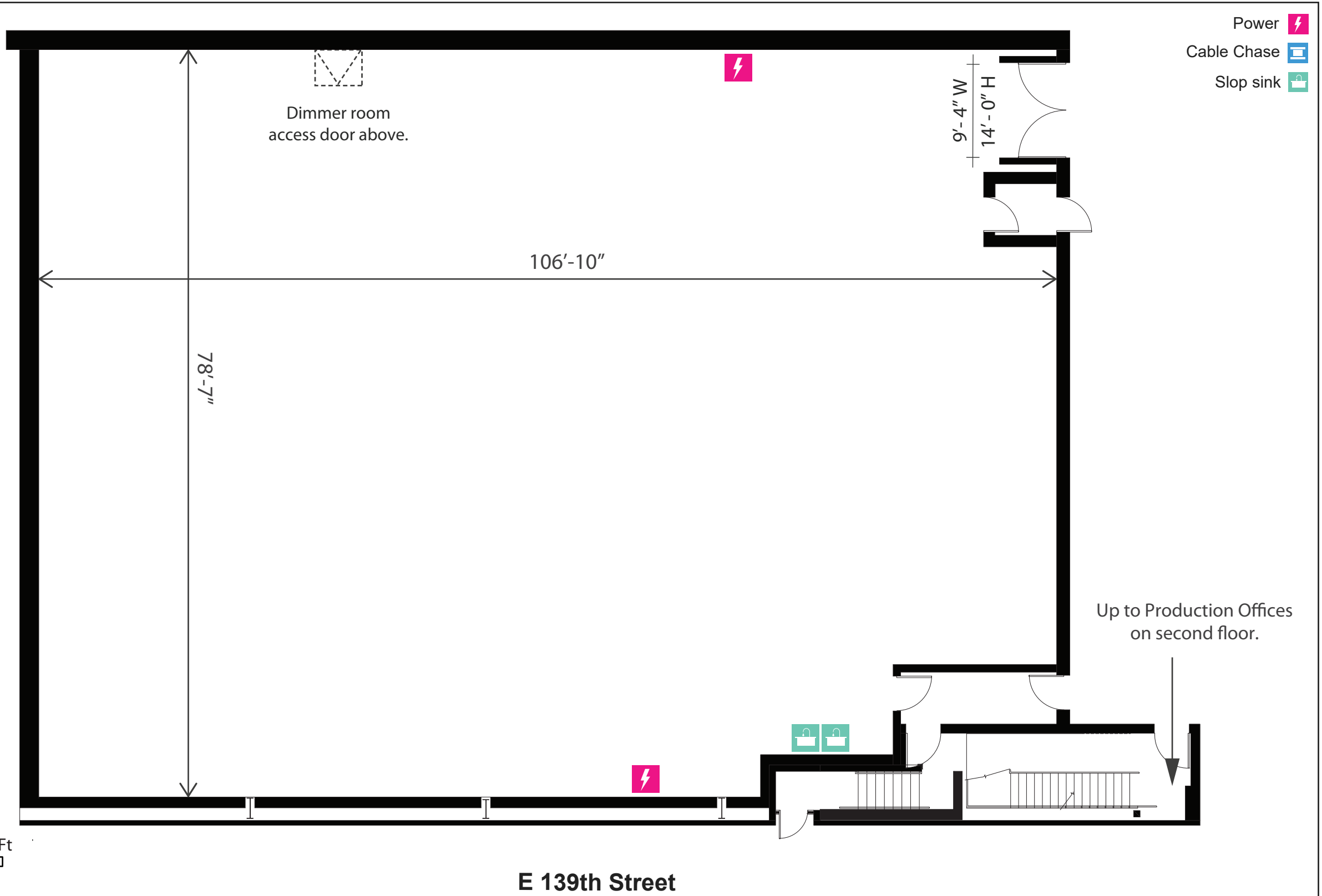
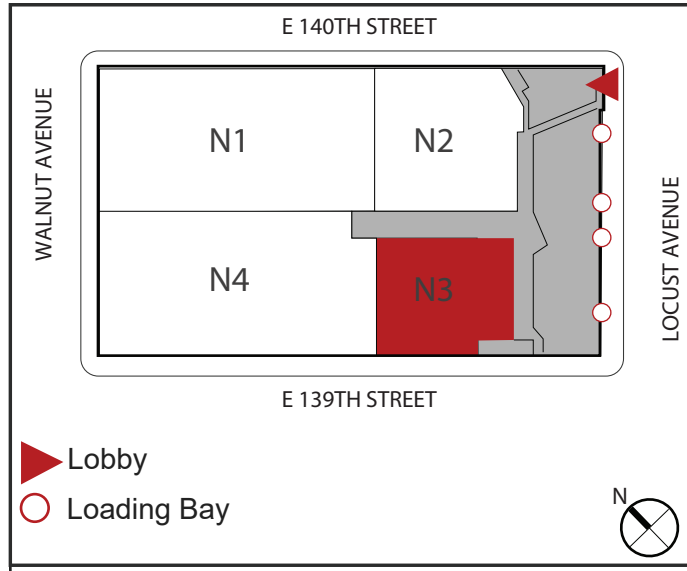

2 Power Panels each 1200Amps located in the Dimmer Rm.- To be pulled from access door.  
Additional shared 4800Amps in the hallway.

SILVERCUP STUDIOS	Length	Width	Ht to Grid	Ht to Truss	Approx Area	Power	AC	Floor type	Cyc
	106'- 10"	78'-7"	50'- 0"	49'-0"	8,030 sqft	4800 Amps	50 Tons	Finished Concrete	None

# STAGE N4

## Key Plan

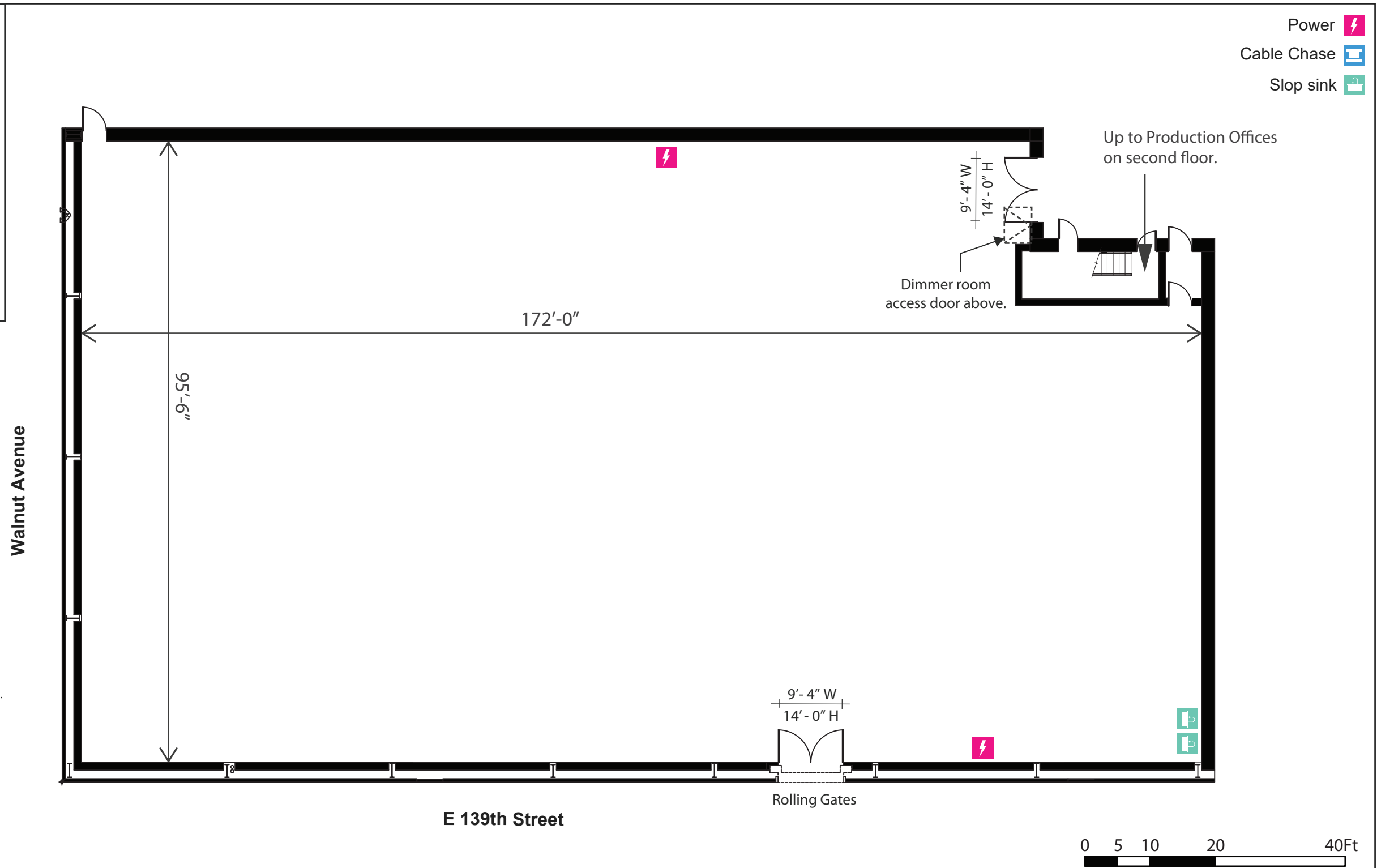
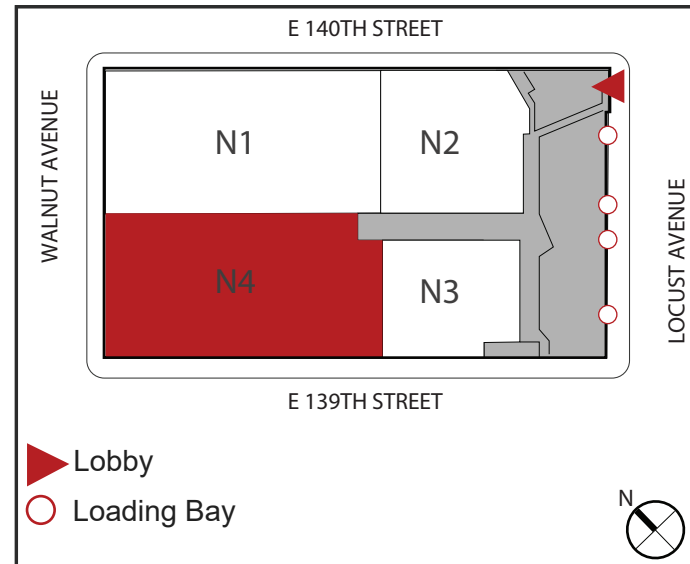

2 Power Panels each 1200Amps located in the Dimmer Rm.- To be pulled from access door.  
Additional shared 4800Amps in the hallway.

SILVERCUP STUDIOS	Length	Width	Ht to Grid	Ht to Truss	Approx Area	Power	AC	Floor type	Cyc
	172'- 0"	95'-6"	50'- 0"	49'-0"	15,875 sqft	4800 Amps	100 Tons	Finished Concrete	None