

STAGE 1

Key Plan

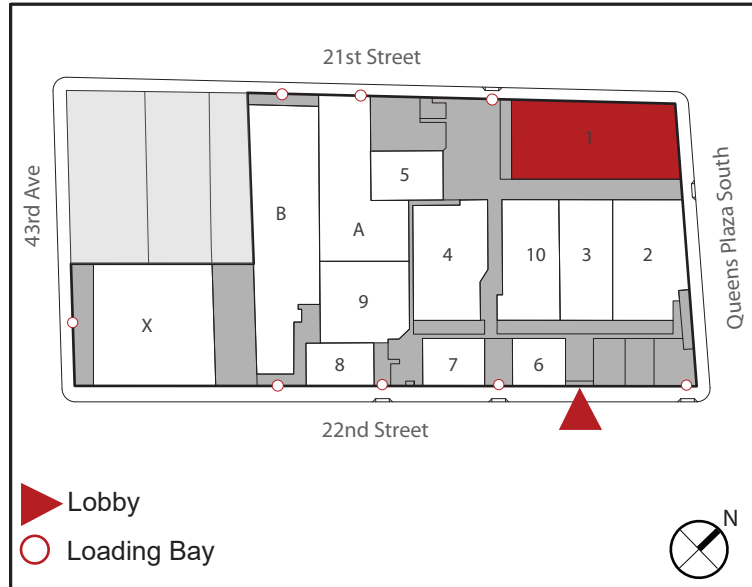

- Power
- Cable Chase
- Slop sink

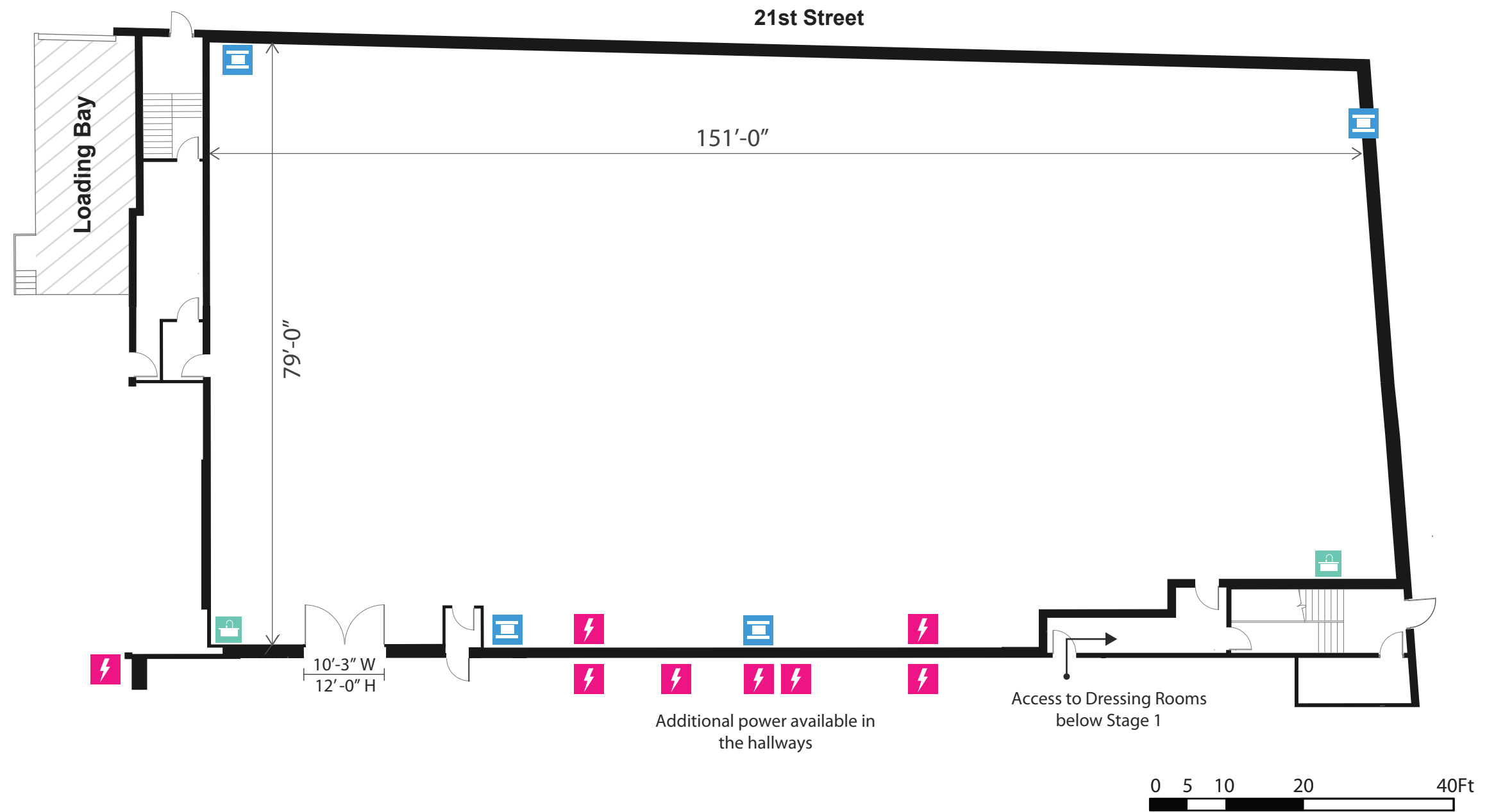

	Length	Width	Ht to Grid	Ht to Truss	Approx Area	Power	AC	Floor type	Cyc
	151'-0"	79'-0"	17'-7"	15'-9"	12,300 sqft	2400 Amps	80 Tons	Wood over Concrete	None