

STAGE 2

Key Plan

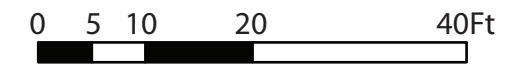
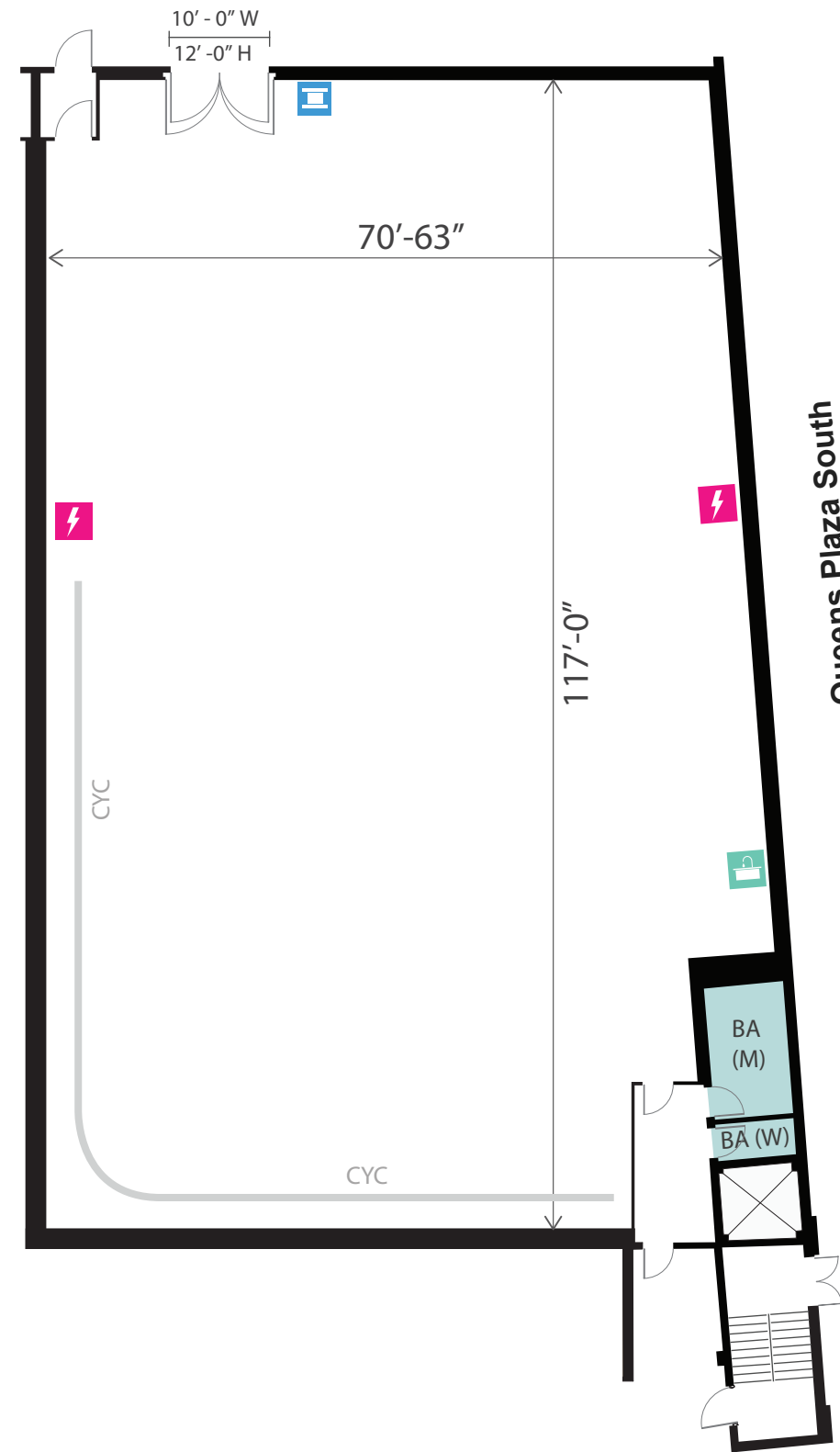

SILVERCUP STUDIOS	Length	Width	Ht to Grid	Ht to truss	Approx. Area	Power	AC	Floor Type	Cyc
	117'-0"	70'-63"	18'-0"	15'-9"	8,000 sqft	2400 Amps	50 Tons	Wood over Concrete	2 Walls 84' X 57'6" X 18'H