

STAGE 5

Key Plan

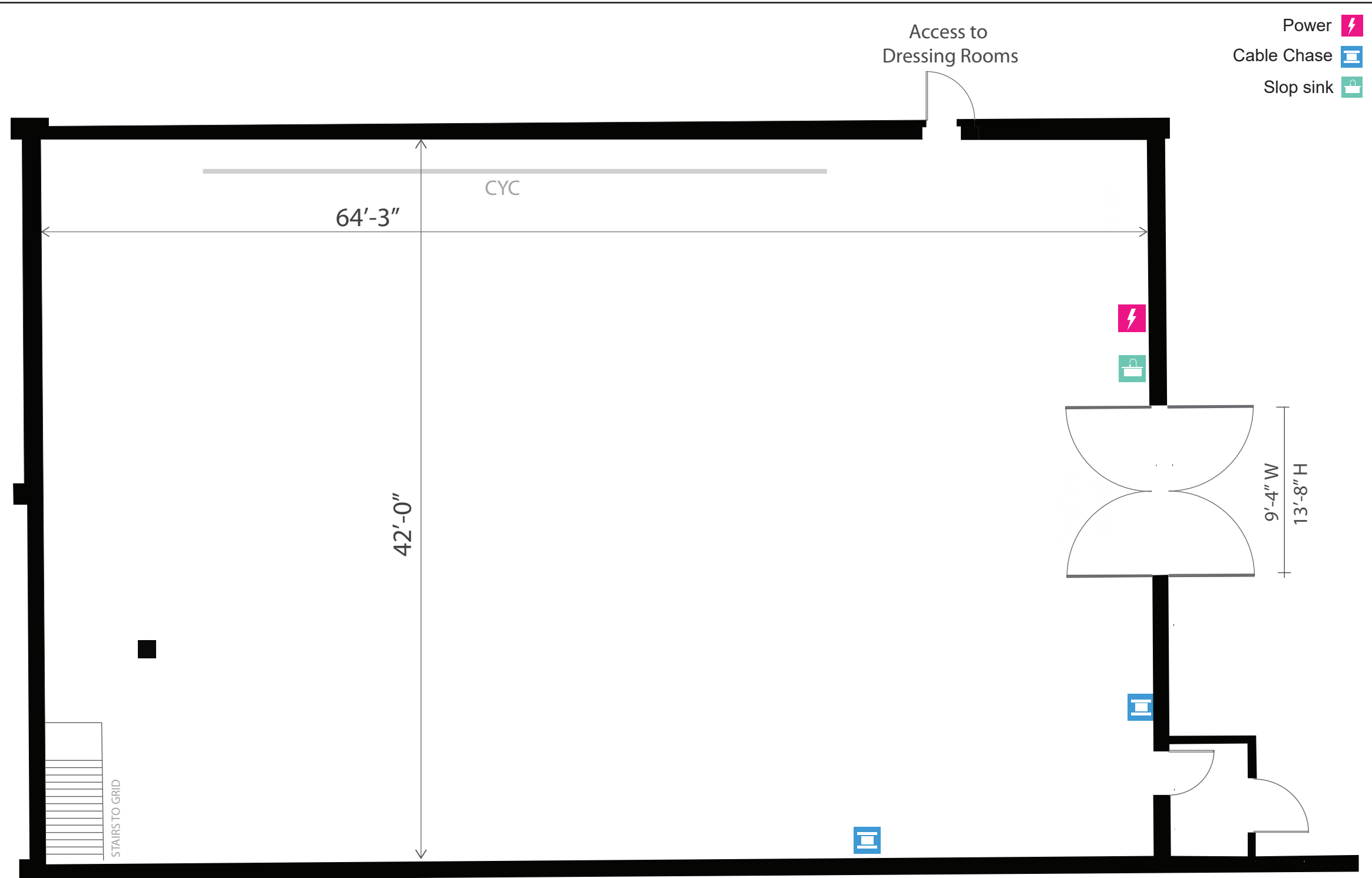

- Power
- Cable Chase
- Slop sink

	Length	Width	Ht to Grid	Ht to Beams	Approx Area	Power	AC	Floor Type	Cyc
	64'- 3"	42'- 0"	33'- 0"	36'- 0"	3,200 sqft	1200 Amps	45 Tons	Wood over Concrete	1 Wall 38'LX 16'H