

# STAGE 9

## Key Plan

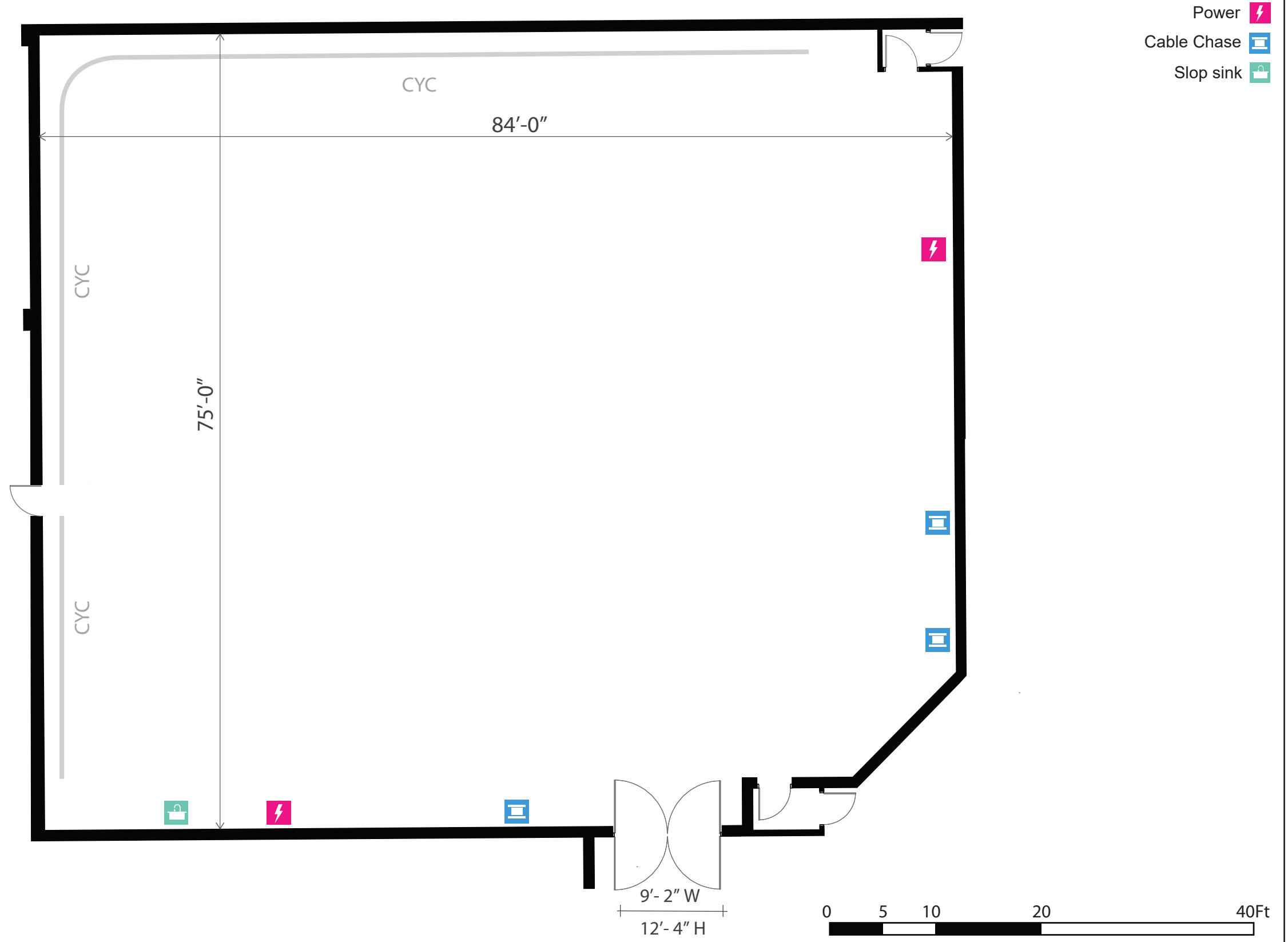
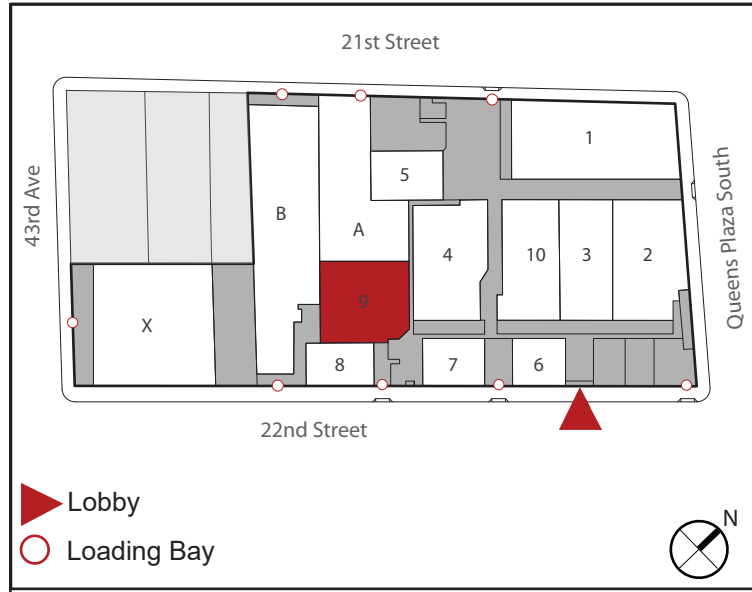

- Power
- Cable Chase
- Slop sink

SILVERCUP STUDIOS	Length	Width	Ht to Grid	Ht to Truss	Approx Area	Power	AC	Floor Type	Cyc
	84'-0"	75'-0"	17'-9"	16'-0"	6,640 sqft	2400 Amps	100 Tons	Wood over Concrete	2 Walls 41'-5" X 72'W X 19'H