

STAGE N3

Key Plan

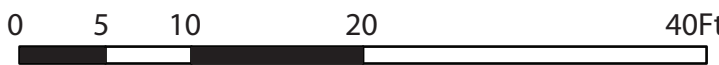
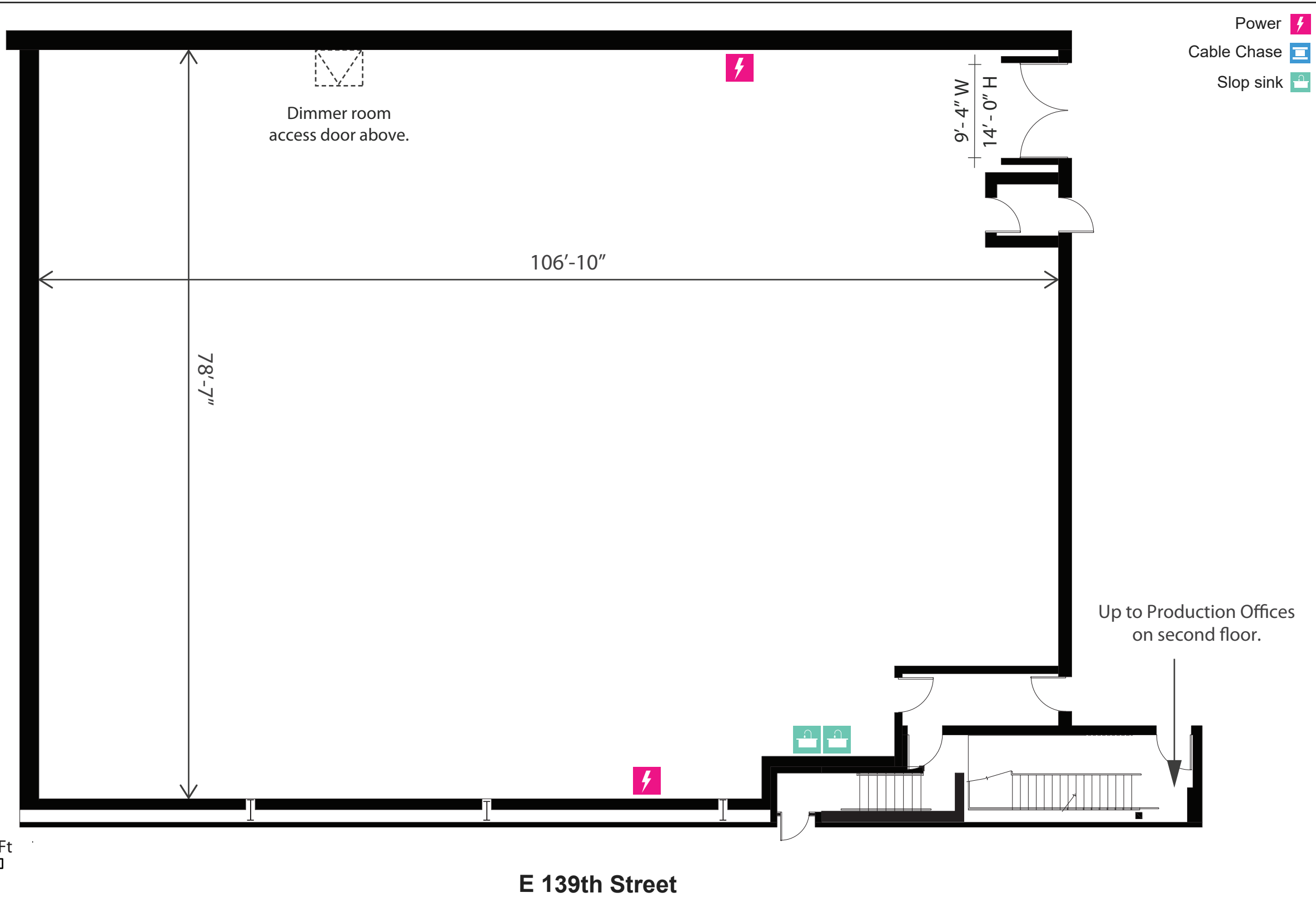
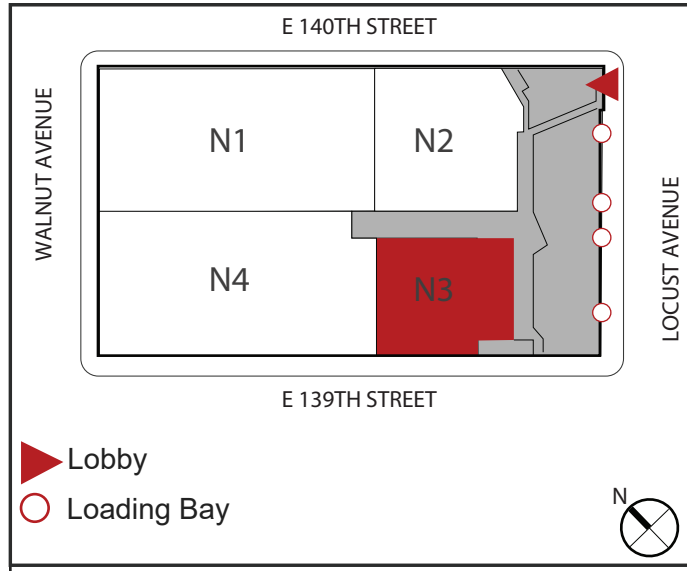

2 Power Panels each 1200Amps located in the Dimmer Rm.- To be pulled from access door.
Additional shared 4800Amps in the hallway.

SILVERCUP STUDIOS	Length	Width	Ht to Grid	Ht to Truss	Approx Area	Power	AC	Floor type	Cyc
	106'- 10"	78'-7"	50'- 0"	49'-0"	8,030 sqft	4800 Amps	50 Tons	Finished Concrete	None